

Note. I have conformed the lines to the original acts variation - one found erroneous and survey and Division was made 1st and second days of November 1796.  
J. E. McLean

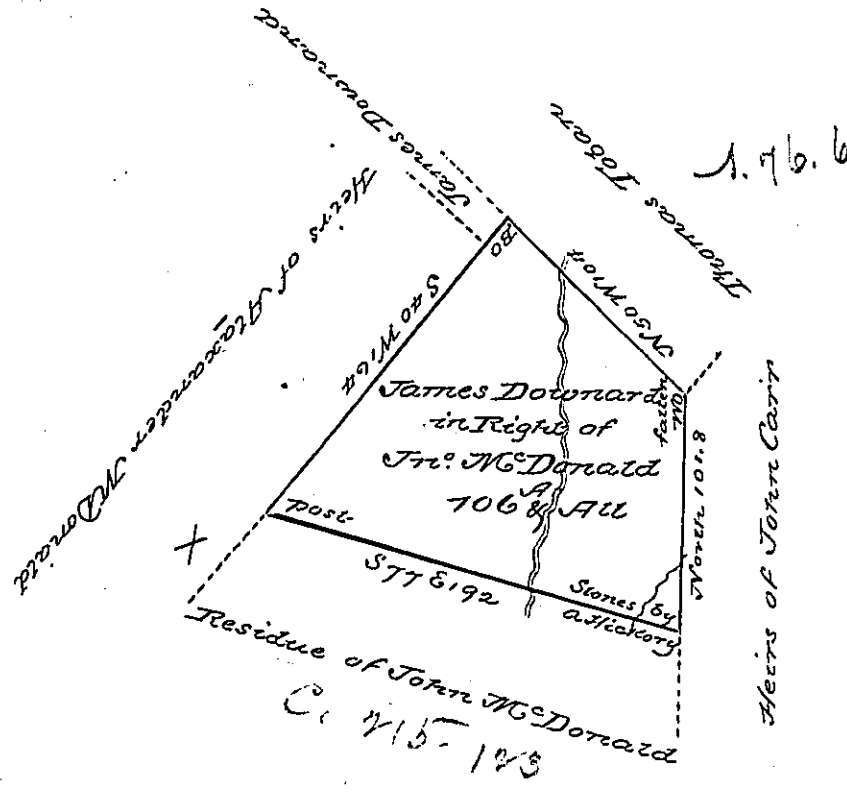

The above is part of a Survey made for John McDonald Senior the 30<sup>th</sup> day of October 1769 by Order of Survey n<sup>o</sup> 3073 dated the 7<sup>th</sup> day of April 1769 - the whole of which tract he by his last Will and Testament dated 12<sup>th</sup> April 1786 did give and bequeath unto his wife - viz "Mary" and his Daughter "Rachel", who intermarried with the above named James Downard - the parties have agreed on a Division and are desirous of having separate patents. I have divided the land with that intent - in doing of which I have discovered some inaccuracy in the Original Survey which I have rectified. Situate on York Run in George Township Fayette County

J. Alexander McLean

To Samuel Cochran Esquire  
Surveyor General

Deputy

IN TESTIMONY that the above is a copy of the original remaining on file in the Department of Internal Affairs of Pennsylvania, made conformably to an Act of Assembly approved the 16th day of February, 1833, I have hereunto set my Hand and caused the Seal of said Department to be affixed at Harrisburg, this sixth day of September 1898

*James W. Little*  
Secretary of Internal Affairs